

BRISTOLITE COPOLYESTER GLAZING HAS BEEN LOAD TESTED AND COMPLIES WITH OSHA - CFRS FOR FALL PROTECTION.

## TRITUFF COPOLYESTER ALUMINUM CURB MOUNTED LOUVERED SMOKE HATCH w/EXTERIOR MANUAL RELEASE

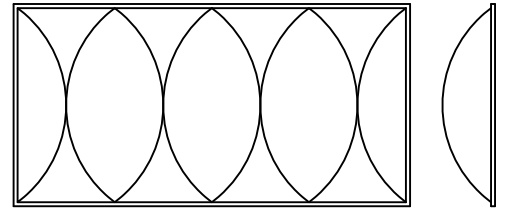

48"x96" OUTER DOME DETAIL

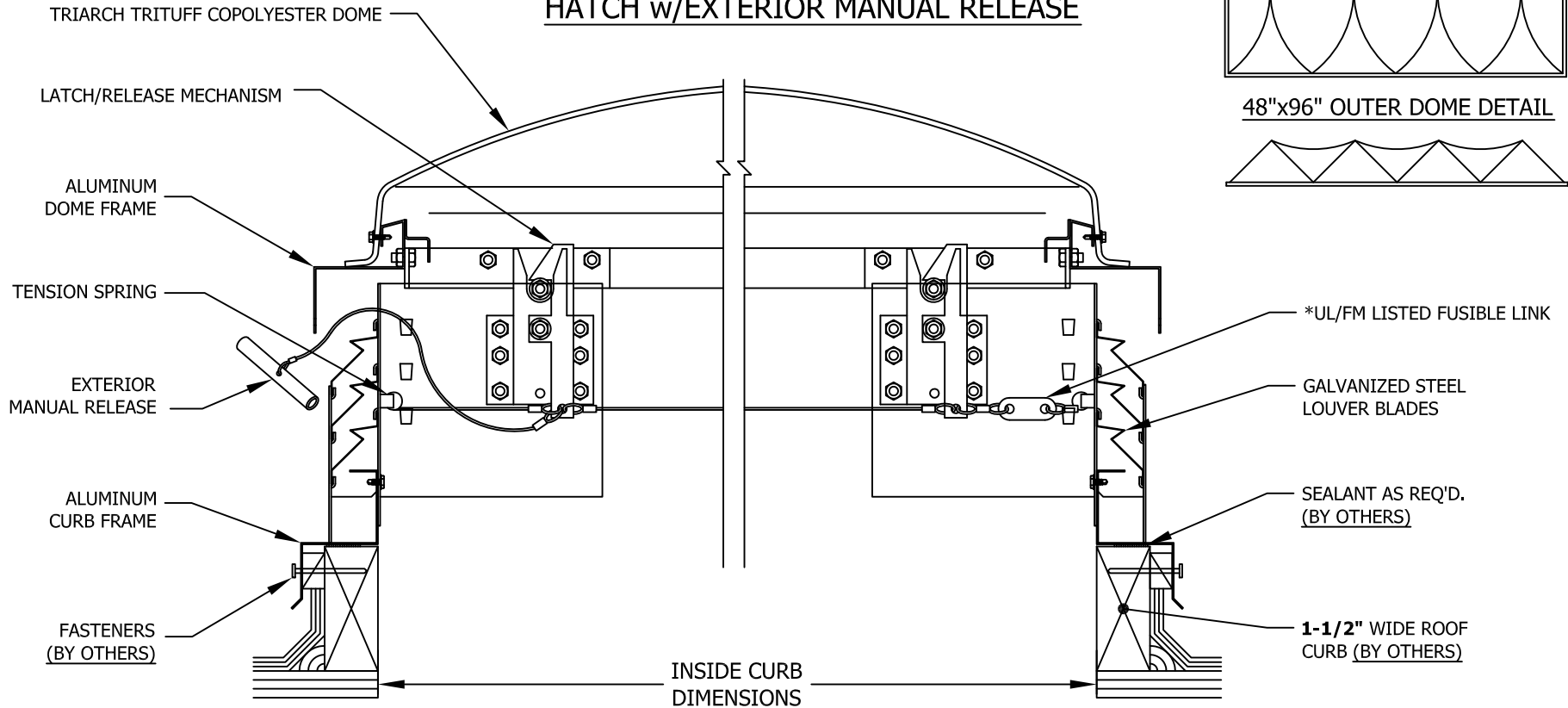
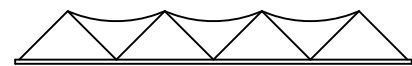

**\* FUSIBLE LINK TEMPERATURE**  
PLEASE SELECT **ONE**:

165°     212°     286°     360°

**MODEL: SVL-CM-1-HS1-M1-MF**  
(NOT TO SCALE)

SVL - ALUMINUM LOUVERED SMOKE HATCH  
CM - CURB MOUNTED  
1 - SINGLE GLAZED  
HS1 - COPOLYESTER TRIARCH DOME

M1 - EXTERIOR MANUAL RELEASE  
MF - MILL FINISH

| MODEL NUMBER | INSIDE CURB DIMENSIONS | QTY |
|--------------|------------------------|-----|
| 4896-SVL-CM  | 48"x96"                |     |
|              |                        |     |
|              |                        |     |

**DOME MATERIAL TESTED IN CONFORMANCE WITH:**

- HIGH WIND RESISTANT - DOME OF THIS UNIT HAS EXCEEDED 90MPH UPLIFT IN TESTING.
- BURN RATE - TRI-TUFF MATERIAL CLASSIFIED AS CC1 MATERIAL.
- TESTED AND MET LOAD REQUIREMENTS PER OSHA 29 CFR 1910.23 (8).
- TESTED AND MET REQUIREMENTS AS DESCRIBED IN "STANDARD PRESENTATION TO CALIFORNIA OCCUPATIONAL SAFETY AND HEALTH STANDARDS BOARD - PROPOSED STATE STANDARD, TITLE 8, CHAPTER 4, SECTION 1632 (REPORT NUMBER 3075015-1).
- TESTING PERFORMED ON 48"x96" DOME.

**\*OPTIONS**  
(NOT SHOWN)

- BS - BIRD SCREEN
- DF - DUST FILTER
- IS - INSECT SCREEN
- RG - RAIN GUARD

**Bristolite® Daylighting Systems**

401 East Goetz Avenue, Santa Ana, CA. 92707  
TEL 714.540.8950 / FAX 714.540.5415

CUSTOMER : \_\_\_\_\_

PROJECT : \_\_\_\_\_

PREPARED BY : \_\_\_\_\_

SUBMITTAL DATE : \_\_\_\_\_

JOB NO : \_\_\_\_\_

ARCHITECT : \_\_\_\_\_