

Industrial Skylight and  
(Optional) Security Grill

**Frame Material**  
Aluminum

Bristolite prismatic glazing has been load tested and complies with OSHA – CFR's for fall protection.

### Prismatic Triarch

Details (Scale: 3":1'-0")

Specifications

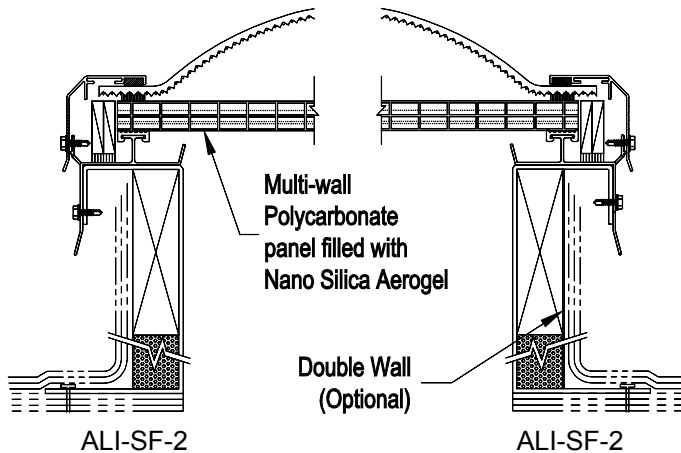

Nano Insulgel Skylight shall be model No. \_\_\_\_\_ as manufactured by Bristolite Daylighting Systems, Santa Ana, CA. The skylight shall be glazed with a plastic dome using prismatic material plus a structural polycarbonate panel filled with nano silica aerogel. The frame is a fabricated 6063-T5 heliarc welded aluminum frame and has an integral condensate channel to carry moisture to the exterior. The aluminum retaining cap fasteners are to be corrosion resistant. The aluminum retaining cap fasteners are to be corrosion resistant. The base frame shall be either a 4", 9", or 12" high self flashing curb, fabricated from aluminum with a 2-3/4" roof flange with 1" of polyisocyanurate rigid insulation and a 1x4 wood nailer. Materials are Approved Plastic CC-2 Rated.

#### Sizes:

Model Number	Inside Curb Dimension	Model Number	Inside Curb Dimension	Model Number	Inside Curb Dimension	Model Number	Inside Curb Dimension
1414-ALI	14 1/4" x 14 1/4"	6060-ALI	60" x 60"	2448-ALI	24 1/4" x 48"	3775-ALI	37" x 75"
1919-ALI	19" x 19"			2496-ALI	24 1/4" x 96"	3859-ALI	38" x 59"
2222-ALI	22 1/4" x 22 1/4"	1422-ALI	14 1/4" x 22 1/4"	3037-ALI	30 1/4" x 37"	4669-ALI	46 1/4" x 69 1/2"
3030-ALI	30 1/4" x 30 1/4"	1446-ALI	14 1/4" x 46 1/4"	3046-ALI	30 1/4" x 46 1/4"	4689-ALI	46 1/4" x 89 1/2"
3737-ALI	37" x 37"	2230-ALI	22 1/4" x 30 1/4"	3069-ALI	30 1/4" x 69 1/2"	4884-ALI	48" x 84"
4242-ALI	42" x 42"	2237-ALI	22 1/4" x 37"	3096-ALI	30 1/4" x 96"	4896-ALI	48" x 96"
4646-ALI	46 1/4" x 46 1/4"	2246-ALI	22 1/4" x 46 1/4"	3496-ALI	34" x 96"	5460-ALI	54" x 60"
4848-ALI	48" x 48"	2272-ALI	22 1/4" x 72"	3696-ALI	36" x 96"	6072-ALI	60" x 72"
5555-ALI	55" x 55"	2296-ALI	22 1/4" x 96"	3746-ALI	37" x 46 1/4"	Call for additional sizes	

Solar Heat Gain Coefficient = .31, U Factor = .37, Visible Light Transmission = 48% (Typical for CM-CPM-CNANO double glazed units)

#### Features:

- Self Flashing (SF)
- Two Prismatic Color Choices: White Prismatic Acrylic (WPM) or Clear Prismatic Acrylic (CPM)
- Insulated Frame (INS)
- Wood Nailer (WN)  
Add highlighted suffixes to model number where applicable:  
i.e. 6072-ALI-SF-2-CPM-16mm-NANO-12-INS-WN-CA

#### Options: (cont.)

- Double Wall Frame (DW)
- Nano Insulgel Panel Thickness: 10mm, 16mm, 20mm & 25mm

#### Accessories: See PDS (Product Data Sheets) for these Items

- Gladiator
  - Security Grills (SG)
  - Safety Screens (SSCRN)
  - External Safety Cages (SCAGE)

#### Options:

- Insulating Double Domes (2)
- Frame Finish - Bronze Anodize (BA), Clear Anodize (CA), White Painted (WP) or Mill Finish (MF)
- Self Flashing Bases of 9" or 12" (9 or 12)