

# Tufflite C/I

## Solar Heat Blocker

### Polycarbonate

Heavy Weather / High Security

Industrial Skylight  
Thermally Broken



Polycarbonate Triarch

## Model ALIT(F)

**Frame Material:** Aluminum

**NFRC:** Certified

**IECC 2015:** Meets without controls all climate zones

**OSHA:** Meets CFR fall regulations

**FM Global:** Passes 4431 2" severe hail test

**AAMA:** WDMA/CSA 101/I.S.2/A440-08 & WDMA/CSA 101/I.S.2/A440-05

#### Details:

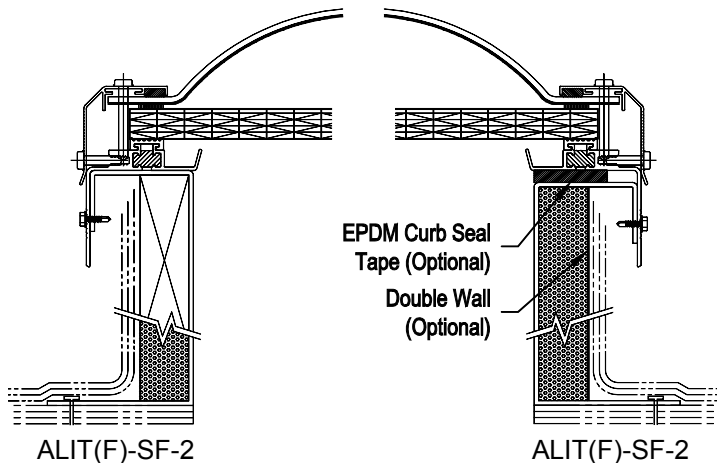

#### Specifications:

Tufflite C/I skylight shall be model No. \_\_\_\_\_ as manufactured by Bristolite Daylighting Systems, Santa Ana, CA. Skylights shall be fully factory assembled consisting of a polycarbonate dome coated with an infra-red and ultraviolet blocking technology with a CC-1 classification that is sealed by interior and exterior gaskets to a 6063-T5 heliarc welded aluminum frame fabricated of aluminum and polyurethane thermal break material to prevent thermal losses through the frame and the formation of condensation on its interior surfaces plus a structural multiwall polycarbonate panel. The frame is to have an integral condensation channel. The aluminum retaining cap is fixed both horizontally and vertically (staggered) with #10 corrosive resistant fasteners at 6" maximum spacing. The skylight frame shall be installed either on a 1-1/2" wide curb furnished by others or on its own 9" or 12" high self flashing curb fabricated from aluminum with a 2-3/4" roof nailing flange. The base is made up with 1" insulation and a wood nailer and/or an additional aluminum liner on the exterior of the self flashing curb.

#### Sizes:

Model Number	Inside Curb Dimension	Model Number	Inside Curb Dimension	Model Number	Inside Curb Dimension	Model Number	Inside Curb Dimension
1414-ALIT(F)	14 1/4" x 14 1/4"	6060-ALIT(F)	60" x 60"	2448-ALIT(F)	24 1/4" x 48"	3775-ALIT(F)	37" x 75"
1919-ALIT(F)	19" x 19"			2496-ALIT(F)	24 1/4" x 96"	3859-ALIT(F)	38" x 59"
2222-ALIT(F)	22 1/4" x 22 1/4"	1422-ALIT(F)	14 1/4" x 22 1/4"	3037-ALIT(F)	30 1/4" x 37"	4669-ALIT(F)	46 1/4" x 69 1/2"
3030-ALIT(F)	30 1/4" x 30 1/4"	1446-ALIT(F)	14 1/4" x 46 1/4"	3046-ALIT(F)	30 1/4" x 46 1/4"	4689-ALIT(F)	46 1/4" x 89 1/2"
3737-ALIT(F)	37" x 37"	2230-ALIT(F)	22 1/4" x 30 1/4"	3069-ALIT(F)	30 1/4" x 69 1/2"	4884-ALIT(F)	48" x 84"
4242-ALIT(F)	42" x 42"	2237-ALIT(F)	22 1/4" x 37"	3096-ALIT(F)	30 1/4" x 96"	4896-ALIT(F)	48" x 96"
4646-ALIT(F)	46 1/4" x 46 1/4"	2246-ALIT(F)	22 1/4" x 46 1/4"	3496-ALIT(F)	34" x 96"	5460-ALIT(F)	54" x 60"
4848-ALIT(F)	48" x 48"	2272-ALIT(F)	22 1/4" x 72"	3696-ALIT(F)	36" x 96"	6072-ALIT(F)	60" x 72"
5555-ALIT(F)	55" x 55"	2296-ALIT(F)	22 1/4" x 96"	3746-ALIT(F)	37" x 46 1/4"		Call for additional sizes

Solar Heat Gain Coefficient = .22, U Factor = .44, Visible Light Transmission = 50% (Typical for PCO double glazed units)

#### Features:

1. Self Flashing (SF)
2. Clear Polycarbonate Dome with Infra-Red & Ultraviolet Blocking Technology (PCO)
3. Insulated Curb (INS)
4. Wood Nailer (WN)
5. Two Inner Multiwall Panel Colors: Clear (C) or Opal (O)
6. 16mm Inner Multiwall Panel (16MM10)  
Add highlighted suffixes to model number where applicable:  
i.e. 4896-ALIT(F)-SF-2-PCO-C16MM10-12-INS-WN-MF

#### Options:

1. Insulating Double Domes (2)

#### Options: (cont.)

2. Frame Finish - Bronze Anodize (BA), Clear Anodize (CA), White Painted (WP) or Mill Finish (MF)
3. Self Flashing Bases of 9" or 12" (9 or 12)
4. Aluminum Double Wall (DW)
5. EPDM Curb Seal Tape

Accessories: See PDS (Product Data Sheets) for these Items

1. Gladiator
  - a. Security Grills (SG)
  - b. Safety Screens (SSCRN)
  - c. External Safety Cages (SCAGE)