

# Tufflite I

## Polycarbonate

Heavy Weather / High Security

Industrial Skylight  
w/Thermal Barrier Break

### Polycarbonate Dome

## Model ALIB

**Frame Material:** Aluminum  
**NFRC:** Certified  
**IECC 2015:** Meets without controls all climate zones  
**OSHA:** Meets CFR fall regulations  
**FM Global:** Passes 4431 2" severe hail test  
**AAMA:** WDMA/CSA 101/I.S.2/A440-08 & WDMA/CSA 101/I.S.2/A440-05

#### Details:

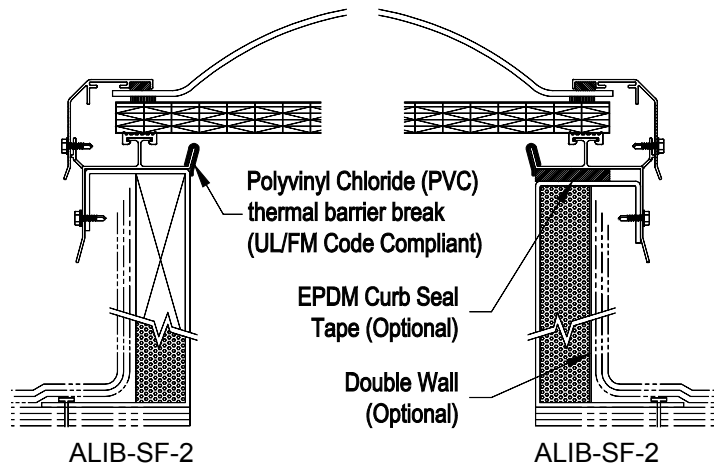

#### Specifications:

Tufflite I skylight shall be model No. \_\_\_\_\_ as manufactured by Bristolite Daylighting Systems, Santa Ana, CA. Skylights shall be fully factory assembled consisting of a polycarbonate dome with a CC-1 classification that is sealed by interior and exterior gaskets to a 6063-T5 heliarc welded aluminum frame plus a structural multiwall polycarbonate panel and a polyvinyl chloride (PVC) thermal barrier break (UL/FM Code Compliant) to prevent thermal losses through the frame and the formation of condensation on its interior surfaces plus a structural multiwall polycarbonate glazing panel. The frame is to have an integral condensation channel to carry moisture to the exterior. The aluminum retaining cap fasteners are to be corrosive resistant. The skylight frame shall be installed on its own 9" or 12" high self flashing curb fabricated from aluminum with a 2-3/4" roof nailing flange. The base is made up with 1" insulation and a wood nailer and/or an additional aluminum liner on the exterior of the self flashing curb.

#### Sizes:

Model Number	Inside Curb Dimension	Model Number	Inside Curb Dimension	Model Number	Inside Curb Dimension	Model Number	Inside Curb Dimension
1414-ALIB	14 1/4" x 14 1/4"	6060-ALIB	60" x 60"	2272-ALIB	22 1/4" x 72"	3746-ALIB	37" x 46 1/4"
1919-ALIB	19" x 19"	7070-ALIB	70 1/4" x 70 1/4"	2296-ALIB	22 1/4" x 96"	3775-ALIB	37" x 75"
2222-ALIB	22 1/4" x 22 1/4"	7575-ALIB	75" x 75"	2448-ALIB	24" x 48"	3859-ALIB	38" x 59"
3030-ALIB	30 1/4" x 30 1/4"			2496-ALIB	24" x 96"	4669-ALIB	46 1/4" x 69 1/2"
3737-ALIB	37" x 37"	1422-ALIB	14 1/4" x 22 1/4"	3037-ALIB	30 1/4" x 37"	4689-ALIB	46 1/4" x 89 1/2"
4242-ALIB	42" x 42"	1446-ALIB	14 1/4" x 46 1/4"	3046-ALIB	30 1/4" x 46 1/4"	4896-ALIB	48" x 96"
4646-ALIB	46 1/4" x 46 1/4"	2230-ALIB	22 1/4" x 30 1/4"	3069-ALIB	30 1/4" x 69 1/2"	5460-ALIB	54" x 60"
4848-ALIB	48" x 48"	2237-ALIB	22 1/4" x 37"	3096-ALIB	30 1/4" x 96"	6072-ALIB	60" x 72"
5555-ALIB	55" x 55"	2246-ALIB	22 1/4" x 46 1/4"	3496-ALIB	34" x 96"		Call for additional sizes

Solar Heat Gain Coefficient = .20, U Factor = .44, Visible Light Transmission = 58% (Typical for WPC double glazed units)

#### Features:

1. Self Flashing (SF)
2. Three Polycarbonate Colors: Medium White Translucent (WPC), Bronze (BPC) or Clear (CPC)
3. Insulated Curb (INS)
4. Wood Nailer (WN)
5. Two Inner Multiwall Panel Colors: Clear (C) or Opal (O)
6. 16mm Inner Multiwall Panel (16MM10)  
Add highlighted suffixes to model number where applicable:  
i.e. 4896-ALIB-SF-2-WPC-C16MM10-12-INS-WN-MF

#### Options:

1. Insulating Double Domes (2)
2. Pyramid (P) or Double Hip (DH) Shaped Dome (selected sizes)
3. Low Profile Dome (LP) (selected sizes)

#### Options: (cont.)

4. Frame Finish - Bronze Anodize (BA), Clear Anodize (CA), White Painted (WP) or Mill Finish (MF)
5. Self Flashing Bases of 9" or 12" (9 or 12)
6. Aluminum Double Wall (DW)
7. EPDM Curb Seal Tape

#### Accessories: See PDS (Product Data Sheets) for these Items

1. Gladiator
  - a. Security Grills (SG)
  - b. Safety Screens (SSCRN)
  - c. External Safety Cages (SCAGE)