

Industrial Skylight  
 Thermally Broken



Polycarbonate Dome

**Model ALT(F)**

**Frame Material:** Aluminum  
**NFRC:** Certified  
**IECC 2015:** Meets without controls climate zone 1, meets with controls climate zones 2-8  
**OSHA:** Meets CFR fall regulations  
**FM Global:** Passes 4431 2" severe hail test  
**AAMA:** WDMA/CSA 101/I.S.2/A440-08 & WDMA/CSA 101/I.S.2/A440-05

Details:

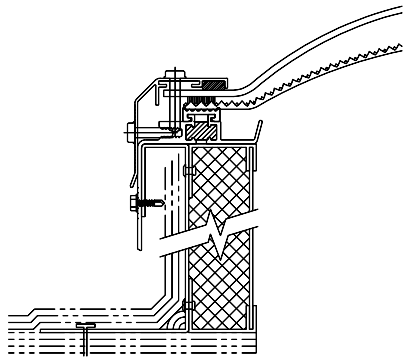

ALT(F)-SF-2

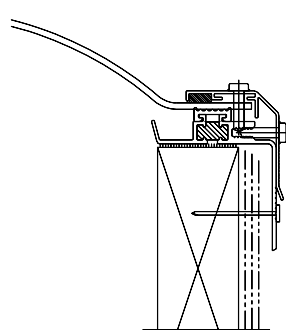

ALT(F)-CM-1

Specifications:

Tufflite skylight shall be model No. \_\_\_\_\_ as manufactured by Bristolite Daylighting Systems, Santa Ana, CA. Skylights shall be fully factory assembled consisting of a polycarbonate dome with a CC-1 classification that is sealed by interior and exterior gaskets to a 6063-T5 heliarc welded aluminum frame fabricated of aluminum and polyurethane thermal break material to prevent thermal losses through the frame and the formation of condensation on its interior surfaces. The frame is to have an integral condensation channel. The aluminum retaining cap is fixed both horizontally and vertically (staggered) with #10 corrosive resistant fasteners at 6" maximum spacing. The skylight frame shall be installed either on a 1-1/2" wide curb furnished by others or on its own 4", 9", or 12" high self flashing curb fabricated from aluminum with a 2-3/4" roof nailing flange with 1" of insulation in a PVC frame and an aluminum liner on the interior of the self flashing curb.

Sizes:

Model Number	Inside Curb Dimension	Model Number	Inside Curb Dimension	Model Number	Inside Curb Dimension	Model Number	Inside Curb Dimension
1414-ALT(F)	14 1/4" x 14 1/4"	6060-ALT(F)	60" x 60"	2448-ALT(F)	24" x 48"	3775-ALT(F)	37" x 75"
1919-ALT(F)	19" x 19"			2496-ALT(F)	24" x 96"	3859-ALT(F)	38" x 59"
2222-ALT(F)	22 1/4" x 22 1/4"	1422-ALT(F)	14 1/4" x 22 1/4"	3037-ALT(F)	30 1/4" x 37"	4669-ALT(F)	46 1/4" x 69 1/2"
3030-ALT(F)	30 1/4" x 30 1/4"	1446-ALT(F)	14 1/4" x 46 1/4"	3046-ALT(F)	30 1/4" x 46 1/4"	4689-ALT(F)	46 1/4" x 89 1/2"
3737-ALT(F)	37" x 37"	2230-ALT(F)	22 1/4" x 30 1/4"	3069-ALT(F)	30 1/4" x 69 1/2"	4884-ALT(F)	48" x 84"
4242-ALT(F)	42" x 42"	2237-ALT(F)	22 1/4" x 37"	3096-ALT(F)	30 1/4" x 96"	4896-ALT(F)	48" x 96"
4646-ALT(F)	46 1/4" x 46 1/4"	2246-ALT(F)	22 1/4" x 46 1/4"	3496-ALT(F)	34" x 96"	5460-ALT(F)	54" x 60"
4848-ALT(F)	48" x 48"	2272-ALT(F)	22 1/4" x 72"	3696-ALT(F)	36" x 96"	6072-ALT(F)	60" x 72"
5555-ALT(F)	55" x 55"	2296-ALT(F)	22 1/4" x 96"	3746-ALT(F)	37" x 46 1/4"	Call for additional sizes	

Solar Heat Gain Coefficient = .26, U Factor = .71, Visible Light Transmission = 60% (Typical for CPC/WPC double glazed units)

Features:

1. Curb Mounted (**CM**) or Self Flashing (**SF**)
  2. Three Polycarbonate Colors: Medium White Translucent (**WPC**), Bronze (**BPC**) or Clear (**CPC**)
  3. Insulated Curb (self flashing models only)
  4. Double Wall Frame (self flashing models only)
- Add highlighted suffixes to model number where applicable:  
 i.e. **4896-ALT(F)-CMT-2-CPC-WPC-CA**

Options:

1. Insulating Double Domes (**2**) or Single Dome (**1**)
2. Frame Finish - Bronze Anodize (**BA**), Clear Anodize (**CA**), White Painted (**WP**) or Mill Finish (**MF**)
3. Self Flashing Bases of 9" or 12" (**9** or **12**)
4. EPDM Curb Seal Tape (**CMT**)

Accessories: See PDS (Product Data Sheets) for these Items

1. Gladiator
  - a. Structural Curb (**SC**)
  - b. Security Grills (**SG**)
  - c. Safety Screens (**SSCRN**)
  - d. External Safety Cages (**SCAGE**)
2. Quickkit (Installation Kits)
  - a. Stainless Steel (**QKSS**)
  - b. Zinc Plated (**QKZP**)

