

Industrial Skylight and  
 (Optional) Security Grill

Bristolite polycarbonate glazing has been load tested and complies with OSHA – CFR's for fall protection.

**Polycarbonate Dome**

Details (Scale: 3":1'-0")

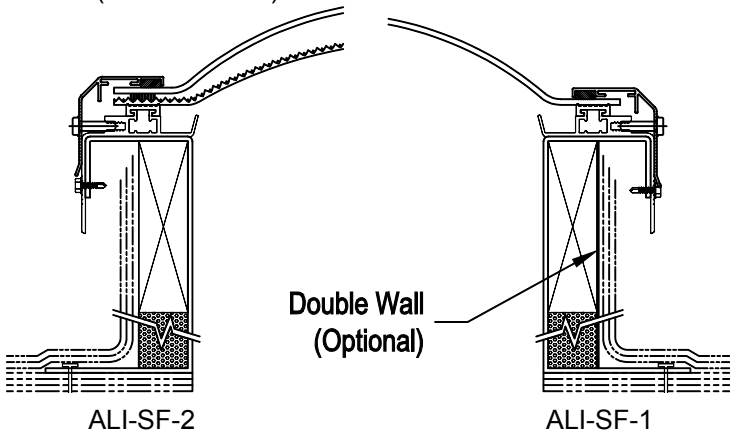

**Specifications**

Tufflite Skylight shall be model No. \_\_\_\_\_ as manufactured by Bristolite Daylighting Systems, Santa Ana, CA. The skylight shall be fully factory assembled consisting of a polycarbonate dome with a CC-1 classification that is sealed by interior and exterior gaskets to a 6063-T5 heliarc welded aluminum frame. The frame is to have an integral condensation channel. The aluminum retaining cap fasteners are to be corrosive resistant. The base frame shall be either a 4", 9" or 12" high self flashing curb, welded to the upper frame, fabricated from aluminum with a 2-3/4" roof flange with 1" of insulation and an additional aluminum liner on the exterior of the self flashing frame.

**Materials tested in conformance with FM 4431 including 2" severe hail test.**

**Sizes:**

Model Number	Inside Curb Dimension	Model Number	Inside Curb Dimension	Model Number	Inside Curb Dimension	Model Number	Inside Curb Dimension
1414-ALI	14 1/4" x 14 1/4"	6060-ALI	60" x 60"	2237-ALI	22 1/4" x 37"	3746-ALI	37" x 46 1/4"
1919-ALI	19" x 19"	7070-ALI	70 1/4" x 70 1/4"	2246-ALI	22 1/4" x 46 1/4"	3775-ALI	37" x 75"
2222-ALI	22 1/4" x 22 1/4"	7575-ALI	75" x 75"	2272-ALI	22 1/4" x 72"	3859-ALI	38" x 59"
3030-ALI	30 1/4" x 30 1/4"	8484-ALI	84" x 84"	2296-ALI	22 1/4" x 96"	4669-ALI	46 1/4" x 69 1/2"
3737-ALI	37" x 37"	9292-ALI	92 1/2" x 92 1/2"	3037-ALI	30 1/4" x 37"	4689-ALI	46 1/4" x 89 1/2"
4242-ALI	42" x 42"			3046-ALI	30 1/4" x 46 1/4"	4896-ALI	48" x 96"
4646-ALI	46 1/4" x 46 1/4"	1422-ALI	14 1/4" x 22 1/4"	3069-ALI	30 1/4" x 69 1/2"	5460-ALI	54" x 60"
4848-ALI	48" x 48"	1446-ALI	14 1/4" x 46 1/4"	3096-ALI	30 1/4" x 96"	6072-ALI	60" x 72"
5555-ALI	55" x 55"	2230-ALI	22 1/4" x 30 1/4"	3496-ALI	34" x 96"	6096-ALI	60" x 96"

Solar Heat Gain Coefficient = .54, U Factor = .55, Visible Light Transmission = 60% (Typical for WPC double glazed units)

**Features:**

1. Welded Self Flashing (SF)
2. Three Polycarbonate Colors: Medium White Translucent (WPC), Bronze (BPC) or Clear (CPC)
3. Insulated Frame (INS)  
 Add highlighted suffixes to model number where applicable:  
 i.e. **6072-ALI-SF-2-CPC/WPC-LP-INS-MF**

**Options: (cont.)**

5. Impact Modified Prismatic Acrylic Glazing (WPM/CPM) Up to and including 4896 and 6072, no larger
6. Frame Finish - Bronze Anodize (BA), Clear Anodize (CA), White Painted (WP) or Mill Finish (MF)
7. Self Flashing Bases of 9" or 12" (9 or 12)
8. Double Wall Frame (DW)
9. Wood Nailer (WN)

**Options:**

1. Insulating Double Domes (2) or Single Dome (1)
2. Pyramid (P) or Double Hip (DH) Shaped Dome (selected sizes)
3. Polycarbonate Dome (PC) (inner dome only)
4. Low Profile Dome (LP) (selected sizes)

**Accessories: See PDS (Product Data Sheets) for these Items**

1. Gladiator
  - a. Security Grills (SG)
  - b. Safety Screens (SSCRN)