

# Coollite

## Solar Heat Blocker Acrylic

Industrial Skylight  
w/Thermal Barrier Break



Acrylic Dome



## Model ALIB

**Frame Material:** Aluminum  
**NFRC:** Certified  
**IECC 2015:** Meets without controls climate zone 1, meets with controls climate zones 2-8  
**OSHA:** Meets CFR fall regulations  
**AAMA:** WDMA/CSA 101/I.S.2/A440-08 & WDMA/CSA 101/I.S.2/A440-05

### Details:

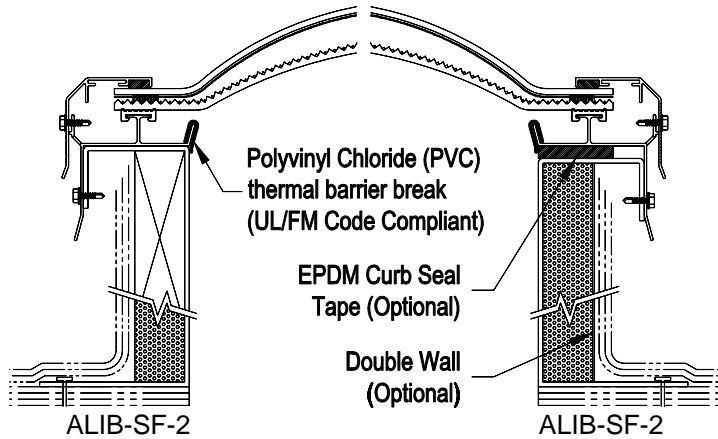

### Specifications:

Coollite skylight shall be model No. \_\_\_\_\_ as manufactured by Bristolite Daylighting Systems, Santa Ana, CA. Skylights shall be fully factory assembled consisting of prismatic material and an acrylic glazing covered with a specially formulated infrared and ultraviolet light reflecting coating with a CC-2 classification that is sealed by interior and exterior gaskets to a 6063-T5 heliarc welded aluminum frame fabricated of aluminum with a polyvinyl chloride (PVC) thermal barrier break (UL/FM Code Compliant) to prevent thermal losses through the frame and the formation of condensation on its interior surfaces. The frame is to have an integral condensation channel to carry moisture to the exterior. The aluminum retaining cap fasteners are to be corrosive resistant. The skylight frame shall be installed either on a 1-1/2" wide curb furnished by others or on its own 9", or 12" high self flashing curb fabricated from aluminum with a 2-3/4" roof nailing flange. The base is made up with 1" insulation and a wood nailer and/or an additional aluminum liner on the exterior of the self flashing curb.

### Sizes:

Model Number	Inside Curb Dimension	Model Number	Inside Curb Dimension	Model Number	Inside Curb Dimension	Model Number	Inside Curb Dimension
1414-ALIB	14 1/4" x 14 1/4"	6060-ALIB	60" x 60"	3496-ALIB	34" x 96"	4884-ALIB	48" x 84"
1919-ALIB	19" x 19"			3696-ALIB	36" x 96"	4896-ALIB	48" x 96"
2222-ALIB	22 1/4" x 22 1/4"	2296-ALIB	22 1/4" x 96"	36120-ALIB	36" x 120"	48120-ALIB	48" x 120"
3030-ALIB	30 1/4" x 30 1/4"	2448-ALIB	24" x 48"	3746-ALIB	37" x 46 1/4"	5460-ALIB	54" x 60"
3737-ALIB	37" x 37"	2496-ALIB	24" x 96"	3775-ALIB	37" x 75"	6072-ALIB	60" x 72"
4242-ALIB	42" x 42"	3037-ALIB	30 1/4" x 37"	3859-ALIB	38" x 59"	6084-ALIB	60" x 84"
4646-ALIB	46 1/4" x 46 1/4"	3046-ALIB	30 1/4" x 46 1/4"	4669-ALIB	46 1/4" x 69 1/2"	6096-ALIB	60" x 96"
4848-ALIB	48" x 48"	3069-ALIB	30 1/4" x 69 1/2"	4689-ALIB	46 1/4" x 89 1/2"	60120-ALIB	60" x 120"
5555-ALIB	55" x 55"	3096-ALIB	30 1/4" x 96"	4872-ALIB	48" x 72"		Call for additional sizes

Solar Heat Gain Coefficient = .26, U Factor = .71, Visible Light Transmission = 54% (Typical for ACO/CPM double glazed units)

### Features:

1. Self Flashing (SF)
2. Clear Acrylic Dome with Infra-Red & Ultraviolet Blocking Technology (ACO)
3. Two Prismatic Color Choices (inner dome only): White Prismatic Acrylic (WPM) or Clear Prismatic Acrylic (CPM)
4. Insulated Curb (INS)
5. Wood Nailer (WN)  
Add highlighted suffixes to model number where applicable:  
i.e. 4848-ALIB-SF-2-ACO-CPM-12-INS-WN-MF

### Options:

1. Insulating Double Domes (2) or Single Dome (1)
2. Low Profile Dome (LP) (selected sizes)
3. Frame Finish - Bronze Anodize (BA), Clear Anodize (CA), White Painted (WP) or Mill Finish (MF)

### Options: (cont.)

- 4 Self Flashing Bases of 9" or 12" (9 or 12)
5. Aluminum Double Wall (DW)
6. EPDM Curb Seal Tape

Accessories: See PDS (Product Data Sheets) for these Items

1. Gladiator
  - a. Security Grills (SG)
  - b. Safety Screens (SSCRN)
  - c. External Safety Cages (SCAGE)