

Coollite

Solar Heat Blocker Acrylic

Industrial Skylight and
(Optional) Security Grill



Acrylic/Polycarbonate Dome



Inside View

Model ALI

Frame Material
Aluminum

Meets the International Energy Conservation Code (IECC) and US National Energy Code

Details (Scale: 3":1'-0")

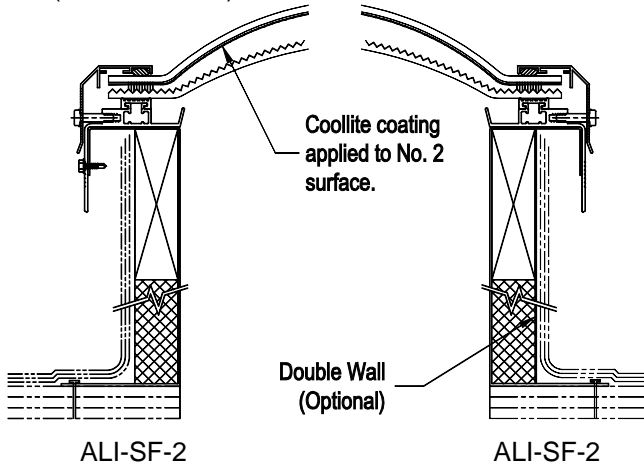

Specifications

Coollite Skylight shall be model No. _____ as manufactured by Bristolite Daylighting Systems, Santa Ana, CA. The skylight shall be glazed with a plastic dome using prismatic and acrylic material covered with a specially formulated infrared and ultraviolet light reflecting coating to a 6063-T5 heliarc welded aluminum frame. The frame is to have an integral condensation channel to carry moisture to the exterior. The aluminum retaining cap fasteners are to be corrosive resistant. The base frame shall be either a 4", 9", or 12" high self flashing curb, welded to the upper frame, fabricated from aluminum with a 2-3/4" roof flange with 1" of insulation and an additional aluminum liner on the exterior of the self flashing frame. Materials are Approved Plastic CC-2 Rated.

Sizes:

Model Number	Inside Curb Dimension	Model Number	Inside Curb Dimension	Model Number	Inside Curb Dimension	Model Number	Inside Curb Dimension
1414-ALI	14 1/4" x 14 1/4"	6060-ALI	60" x 60"	2448-ALI	24 1/4" x 48"	3775-ALI	37" x 75"
1919-ALI	19" x 19"			2496-ALI	24 1/4" x 96"	3859-ALI	38" x 59"
2222-ALI	22 1/4" x 22 1/4"	1422-ALI	14 1/4" x 22 1/4"	3037-ALI	30 1/4" x 37"	4669-ALI	46 1/4" x 69 1/2"
3030-ALI	30 1/4" x 30 1/4"	1446-ALI	14 1/4" x 46 1/4"	3046-ALI	30 1/4" x 46 1/4"	4689-ALI	46 1/4" x 89 1/2"
3737-ALI	37" x 37"	2230-ALI	22 1/4" x 30 1/4"	3069-ALI	30 1/4" x 69 1/2"	4884-ALI	48" x 84"
4242-ALI	42" x 42"	2237-ALI	22 1/4" x 37"	3096-ALI	30 1/4" x 96"	4896-ALI	48" x 96"
4646-ALI	46 1/4" x 46 1/4"	2246-ALI	22 1/4" x 46 1/4"	3496-ALI	34" x 96"	5460-ALI	54" x 60"
4848-ALI	48" x 48"	2272-ALI	22 1/4" x 72"	3696-ALI	36" x 96"	6072-ALI	60" x 72"
5555-ALI	55" x 55"	2296-ALI	22 1/4" x 96"	3746-ALI	37" x 46 1/4"		Call for additional sizes

Solar Heat Gain Coefficient = .26, U Factor = .45, Visible Light Transmission = 54% (Typical for ACO double glazed units)

Features:

1. Self Flashing (SF)
2. Acrylic Coollite Color (ACO) or Polycarbonate Coollite Color (PCO)
3. Two Prismatic Color Choices (inner dome only): White Prismatic Acrylic (WPM) or Clear Prismatic Acrylic (CPM)
4. Insulated Frame (INS)
5. Wood Nailer (WN)

Add highlighted suffixes to model number where applicable:
i.e. 6072-ALI-SF-2-ACO-CPM-9-INS-WN-MF

Options:

1. Insulating Double Domes (2) or Single Dome (1)
2. Low Profile Dome (LP) (selected sizes)

Options: (cont.)

3. Frame Finish - Bronze Anodize (BA), Clear Anodize (CA), White Painted (WP) or Mill Finish (MF)
4. Self Flashing Bases of 9" or 12" (9 or 12)
5. Double Wall Frame (DW)

Accessories: See PDS (Product Data Sheets) for these Items

1. Gladiator
 - a. Security Grills (SG)
 - b. Safety Screens (SSCRN)