

Quasar LowE

Solar Heat Blocker Glazing & Super Insulator Silica Aerogel

Industrial Skylight
w/Thermal Barrier Break



Acrylic/Polycarbonate Dome



Model ALB

Frame Material: Aluminum
NFRC: Certified
IECC 2015: Meets without controls all climate zones
OSHA: Meets CFR fall regulations
AAMA: WDMA/CSA 101/I.S.2/A440-08 & WDMA/CSA 101/I.S.2/A440-05

Details:

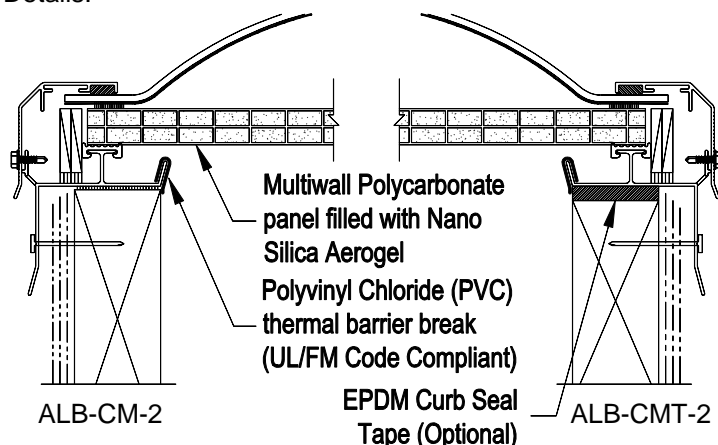

Specifications

Quasar LowE skylight shall be model No. _____ as manufactured by Bristolite Daylighting Systems, Santa Ana, CA. The skylight shall be glazed with a plastic dome using acrylic or polycarbonate material covered with a specially formulated infrared and ultraviolet light reflecting coating plus a structural polycarbonate panel filled with nano silica aerogel to a 6063-T5 heliarc welded aluminum frame fabricated of aluminum with a polyvinyl chloride (PVC) thermal barrier break (UL/FM Code Compliant) to prevent thermal losses through the frame and the formation of condensation on its interior surfaces. The frame is to have an integral condensation channel to carry moisture to the exterior. The aluminum retaining cap fasteners are to be corrosive resistant. The skylight frame shall be installed on a 1-1/2" wide curb furnished by others.

Sizes:

Model Number	Inside Curb Dimension	Model Number	Inside Curb Dimension	Model Number	Inside Curb Dimension	Model Number	Inside Curb Dimension
1414-ALB	14 1/4" x 14 1/4"	6060-ALB	60" x 60"	2448-ALB	24" x 48"	3775-ALB	30 1/4" x 96"
1919-ALB	19" x 19"			2496-ALB	24" x 96"	3859-ALB	34" x 96"
2222-ALB	22 1/4" x 22 1/4"	1422-ALB	14 1/4" x 22 1/4"	3037-ALB	30 1/4" x 37"	4669-ALB	36" x 96"
3030-ALB	30 1/4" x 30 1/4"	1446-ALB	14 1/4" x 46 1/4"	3046-ALB	30 1/4" x 46 1/4"	4689-ALB	37" x 46 1/4"
3737-ALB	37" x 37"	2230-ALB	22 1/4" x 30 1/4"	3069-ALB	30 1/4" x 69 1/2"	4884-ALB	37" x 75"
4242-ALB	42" x 42"	2237-ALB	22 1/4" x 37"	3096-ALB	30 1/4" x 96"	4896-ALB	38" x 59"
4646-ALB	46 1/4" x 46 1/4"	2246-ALB	22 1/4" x 46 1/4"	3496-ALB	34" x 96"	5460-ALB	46 1/4" x 69 1/2"
4848-ALB	48" x 48"	2272-ALB	22 1/4" x 72"	3696-ALB	36" x 96"	6072-ALB	46 1/4" x 89 1/2"
5555-ALB	55" x 55"	2296-ALB	22 1/4" x 96"	3746-ALB	37" x 46 1/4"		Call for additional sizes

Solar Heat Gain Coefficient = .24, U Factor = .31, Visible Light Transmission = 49% (Typical for ACO double glazed units)

Features:

1. Curb Mounted (**CM**)
2. Acrylic Coollite (**ACO**) or Polycarbonate Coollite (**PCO**)
Add highlighted suffixes to model number where applicable:
i.e. **6060-ALB-CM-2-ACO-16mm-NANO-BA**

Options:

1. Insulating Double Domes (**2**)
2. Low Profile Dome (selected sizes) (**LP**)
3. Frame Finish - Bronze Anodize (**BA**), Clear Anodize (**CA**), White Painted (**WP**) or Mill Finish (**MF**)
4. EPDM Curb Seal Tape (**CMT**)
5. Nano Insulgel Panel Thickness: **10mm, 16mm, 20mm & 25mm**

Accessories: See PDS (Product Data Sheets) for these Items

1. Gladiator
 - a. Security Grills (**SG**)
 - b. Safety Screens (**SSCRN**)
 - c. External Safety Cages (**SCAGE**)
2. Quickkit (Installation Kits)
 - a. Stainless Steel (**QKSS**)
 - b. Zinc Plated (**QKZP**)