

Quasar LowE

Solar Heat Blocker Glazing & Super Insulator Silica Aerogel

Industrial Skylight
Thermally Broken



Acrylic/Polycarbonate Dome



MODEL ALT

Frame Material: Aluminum
NFRC: Certified
IECC 2015: Meets without controls all climate zones
OSHA: Meets CFR fall regulations
AAMA: WDMA/CSA 101/1.S.2/A440-08 & WDMA/CSA 101/1.S.2/A440-05

Details:

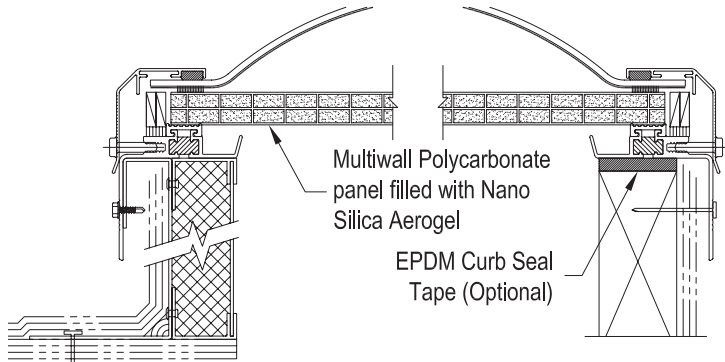

ALT-SF-2

ALT-CMT-2

Specifications:

Quasar LowE skylight shall be model No. ALT as manufactured by Kingspan Light + Air, Santa Ana, CA. The skylight shall be glazed with a plastic dome using acrylic or polycarbonate material covered with a specially formulated infrared and ultraviolet light reflecting coating plus a structural polycarbonate panel filled with nano silica aerogel to a 6063-T5 heliarc welded aluminum frame fabricated of aluminum and polyurethane thermal break material to prevent thermal losses through the frame and the formation of condensation on its interior surfaces. The frame is to have an integral condensation channel to carry moisture to the exterior. The aluminum retaining cap fasteners are to be corrosive resistant. The skylight frame shall be installed either on a 1-1/2" wide curb furnished by others or on its own 4", 9", or 12" high self flashing curb fabricated from aluminum with a 2-3/4" roof nailing flange with 1" of insulation in a PVC frame and an aluminum liner on the interior of the self flashing curb.

Sizes:

Model Number	Inside Curb Dimensions	Model Number	Inside Curb Dimensions	Model Number	Inside Curb Dimensions	Model Number	Inside Curb Dimensions
1414-ALT	14 1/4" x 14 1/4"	6060-ALT	60" x 60"	2448-ALT	24" x 48"	3775-ALT	37" x 75"
1919-ALT	19" x 19"			2496-ALT	24" x 96"	3859-ALT	38" x 59"
2222-ALT	22 1/4" x 22 1/4"	1422-ALT	14 1/4" x 22 1/4"	3037-ALT	30 1/4" x 37"	4669-ALT	46 1/4" x 69 1/2"
3030-ALT	30 1/4" x 30 1/4"	1446-ALT	14 1/4" x 46 1/4"	3046-ALT	30 1/4" x 46 1/4"	4689-ALT	46 1/4" x 89 1/2"
3737-ALT	37" x 37"	2230-ALT	22 1/4" x 30 1/4"	3069-ALT	30 1/4" x 69 1/2"	4884-ALT	48" x 84"
4242-ALT	42" x 42"	2237-ALT	22 1/4" x 37"	3096-ALT	30 1/4" x 96"	4896-ALT	48" x 96"
4646-ALT	46 1/4" x 46 1/4"	2246-ALT	22 1/4" x 46 1/4"	3496-ALT	34" x 96"	5460-ALT	54" x 60"
4848-ALT	48" x 48"	2272-ALT	22 1/4" x 72"	3696-ALT	36" x 96"	6072-ALT	60" x 72"
5555-ALT	55" x 55"	2296-ALT	22 1/4" x 96"	3746-ALT	37" x 46 1/4"		Call for additional sizes

Solar Heat Gain Coefficient = .24, U Factor = .31, Visible Light Transmission = 49% (Typical for ACO double glazed units)

Features:

1. Curb Mounted (**CM**) or Self Flashing (**SF**)
2. Acrylic Coolite (**ACO**) or Polycarbonate Coolite (**PCO**)
3. Insulated Frame (**INS**) (self flashing models only)
4. Double Wall Frame (**DW**) (self flashing models only)
Add highlighted suffixes to model number where applicable: i.e. **6072-ALT-CM-2-ACO-16mm-CNANO-MF**

Options:

1. Insulating Double Domes (**2**)
2. Low Profile Dome (**LP**) (selected sizes)
3. Frame Finish - Bronze Anodize (**BA**), Clear Anodize (**CA**), White Painted (**WP**) or Mill Finish (**MF**)
4. Self Flashing Bases of 9" or 12" (**9** or **12**)
5. EPDM Curb Seal Tape (**CMT**)
6. Nano Insulgel Panel Thickness: **10mm** or **16mm**

Accessories:

 See PDS (Product Data Sheets) for these Items

1. Gladiator
 - a. Structural Curb (**SC**)
 - b. Security Grills (**SG**)
 - c. Safety Screens (**SSCRN**)
 - d. External Safety Cages (**SCAGE**)
2. Quickkit (*Installation Kits*)
 - a. Stainless steel (**QKSS**)
 - b. Zinc plated (**QKZP**)