

PLEASE READ BEFORE INSTALLING

The Quasar Reach dimmer is fully assembled from the factory, but needs to be hardwired to a momentary wall switch. The dimmer installation should be completed in conjunction with **Steps 13 and 14** from the Tubular Skylight installation instructions.

1. The dimmer light pipe assembly is 12" tall and its height must be calculated into the overall light pipe length needed in the attic. The best positioning of the dimmer assembly is at the bottom of the light pipe going into the home (see illustration).

NOTE: If dimmer is installed along with the light kit, the dimmer section **must be placed above** the light kit section.

2. Join the dimmer assembly with the light pipe section with the crimped end down. Secure with the supplied tek screws and seal joints with foil tape.

3. Connect the black and white wires from the dimmer conduit to a nearby electrical box inside the attic area. The dimmer **MUST** be hardwired to a momentary wall switch (not supplied) and not a standard on/off light switch to operate properly.

4. Continue with Step 15 from the Tubular Skylight installation instructions.

DIMMER DIRECTIONS:

The Quasar Reach Tubular Skylight Dimmer is operated using a momentary wall switch. To achieve varying amounts of incoming light, adjust the wall switch to move the dimmer panel until the desired amount of light enters the room (the dimmer panel will rotate 360 degrees).

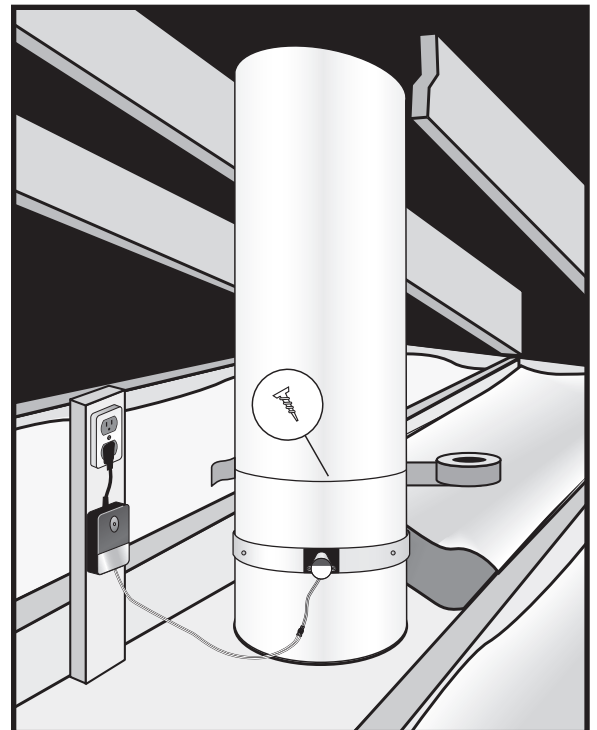
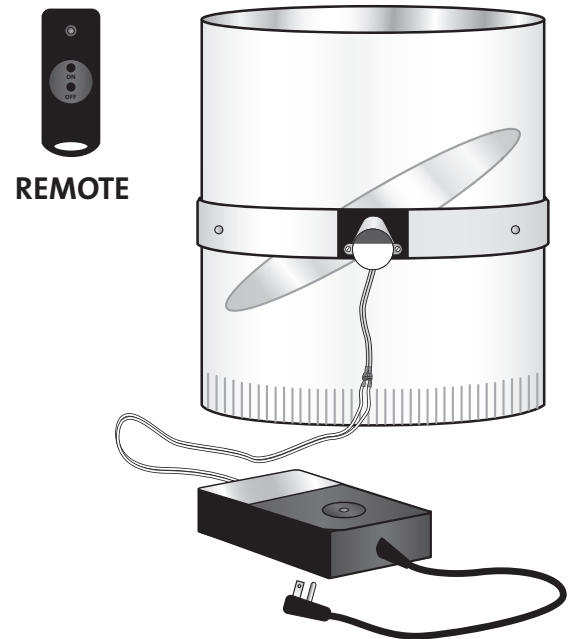

Please fill out the date your purchased the Quasar Reach Dimmer Kit on the warranty certificate below and save for your records

QUASAR REACH WARRANTY

The Quasar Reach Dimmer Kit has a 5 year warranty against manufacturers defects and deterioration.

IMPORTANT: Please complete and mail the registration card below as soon as your Quasar Reach Dimmer Kit is installed. This warranty will serve as proof of your purchase, should you misplace your original invoice.

The manufacturer warrants this product and its components to be free from defects in material and manufacturer's workmanship for a period of five years from the date of installation. This warranty is subject to proper installation of the unit in accordance with the manufacturer's written installation instructions. The manufacturer will not be liable for any special, incidental or consequential damages in any way related to, or arising out of, defects in, or damage to, the Quasar Reach Dimmer Kit.

This warranty gives you specific legal rights, and you may have other rights which vary from state to state concerning exclusion or limitation of incidental or consequential damages.

Date purchased: _____

- Please contact us if you have any questions or to purchase additional accessories. -

Bristolite® Daylighting Systems
harnessing sunlight for energy savings

800.854.8618

www.bristolite.com

401 East Goetz Avenue, Santa Ana, CA 92707

REGISTRATION CARD

Customer name: _____

Where kit was purchased: _____ Date purchased: _____

Street address: _____

City: _____ State: _____ Zip: _____

Phone: _____ Email: _____

Are you satisfied with the performance of the Quasar Reach Dimmer Kit? Yes No

Are you interested in other eco-friendly home products? Yes No

To help us improve our products, please include any comments:

Please fill out the registration card and mail to:

Quasar Reach
Dimmer Kit Registration
401 E. Goetz Avenue
Santa Ana, CA 92707

Quasar Reach
Drop Ceiling Skylights