

TRI-TUFF TRI-ARCH DOME DETAIL

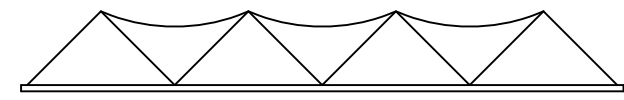

**\* FUSIBLE LINK TEMPERATURE**  
PLEASE SELECT **ONE**:

165°     212°     286°     360°

**CURB MOUNTED SMOKE VENT w/LOUVERS**

**MODEL: SSVL-CM-HS1-MF-OR**

NOT TO SCALE

SSVL - GALVANIZED STEEL FRAME SMOKE VENT W/LOUVERS  
CM - CURB MOUNTED  
HS1 - TRI-TUFF TRI-ARCH DOME

MF - MILL FINISH  
OR - EXTERIOR MANUAL RELEASE

MODEL NUMBER	INSIDE CURB DIMENSIONS	QTY
4848-SSVL-CM	48" x 48"	
4896-SSVL-CM	48" x 96"	

**DOMES MATERIAL TESTED IN CONFORMANCE WITH:**  
 - HIGH WIND RESISTANT - DOME OF THIS UNIT HAS EXCEEDED 90MPH UPLIFT IN TESTING.  
 - BURN RATE - COPOLYESTER MATERIAL CLASSIFIED AS CC1 MATERIAL.  
 - TESTED AND MET LOAD REQUIREMENTS PER OSHA 29 CFR 1910.23 (e) (8).  
 - TESTED AND MET REQUIREMENTS AS DESCRIBED IN STANDARD PRESENTATION TO CALIFORNIA OCCUPATIONAL SAFETY AND HEALTH STANDARDS BOARD - STATE STANDARD, TITLE 8, CHAPTER 4, SECTION 1632 (REPORT NUMBER 3075015-1).  
 - TESTING PERFORMED ON 48" x 96" TRIARCH DOME.

**Bristolite® Daylighting Systems**  
 401 East Goetz Avenue, Santa Ana, CA. 92707  
 TEL 714.540.8950 / FAX 714.540.5415

CUSTOMER :	PREPARED BY :	JOB NO :
PROJECT :	SUBMITTAL DATE :	ARCHITECT :