

Natural Series

UL Listed Dropout



Model
ESSLDOUL

Frame Material
Aluminum

Acrylic Heat/Smoke Vent

Cut Section (N.T.S.)

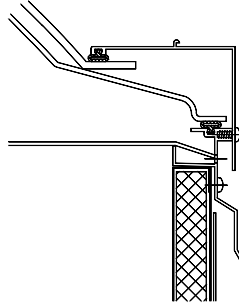
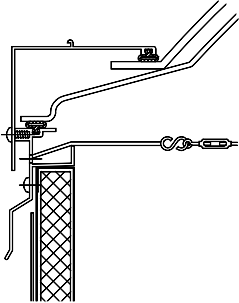

Specifications

Model ESSLDOUL shall be manufactured by Bristolite Daylighting Systems, 100 Metro Dr. Terrell TX 75160, (855) 266-1331. Automatic heat and smoke vent shall be factory assembled for installation on curbs by others. Dropout design shall consist of an outer dome of cast acrylic plastic and a heat activated inner dome of cast acrylic plastic. Frame shall be extruded aluminum with integral condensation gutter. Units shall be designed to drop out when subjected to the UL fire test.

ESSLDOUL-SF-2

ESSLDOUL-SF-2

Sizes:

Model Number	Rough Opening Dimension	Model Number	Rough Opening Dimension
5555-ESSLDOUL	48" x 48"	5566-ESSLDOUL	48" x 60"
		5578-ESSLDOUL	48" x 72"
		5596-ESSLDOUL	48" x 90"
		55102-ESSLDOUL	48" x 96"
Call for additional sizes		Call for additional sizes	

Features:

1. Self Flashing (SF)
2. Underwriters Laboratory (UL) Listed
3. Double glazed **CDO/WDO** for better insulating (2)
4. Single leaf design for more daylighting per unit

Example model number:

5555-ESSLDOUL-CM-2-CDO/WDO-MF

Options:

1. Exterior manual release
2. OSHA complying Gladiator External Safety Cage fall protection