

Nano Insulgel

Super Insulating Silica Aerogel

Industrial Skylight
w/Thermal Barrier Break



Acrylic Dome

Model ALB

Frame Material: Aluminum
NFRC: Certified
IECC 2015: Meets without controls all climate zones
OSHA: Meets CFR fall regulations
AAMA: WDMA/CSA 101/I.S.2/A440-08 & WDMA/CSA 101/I.S.2/A440-05

Details:

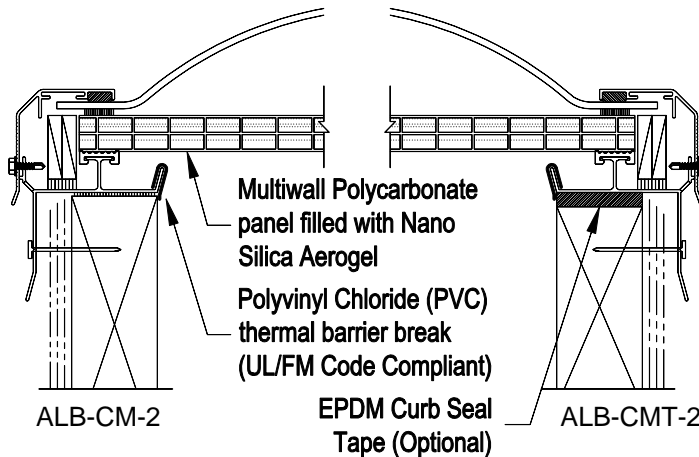

Specifications:

Nano Insulgel skylight shall be model No. _____ as manufactured by Bristolite Daylighting Systems, Santa Ana, CA. Skylights shall be fully factory assembled consisting of an acrylic glazing with a CC-2 classification plus a structural polycarbonate panel filled with nano silica aerogel that is sealed by interior and exterior gaskets to a 6063-T5 heliarc welded aluminum frame fabricated of aluminum with a polyvinyl chloride (PVC) thermal barrier break (UL/FM Code Compliant) to prevent thermal losses through the frame and the formation of condensation on its interior surfaces. The frame is to have an integral condensation channel to carry moisture to the exterior. The aluminum retaining cap fasteners are to be corrosive resistant. The skylight frame shall be installed on a 1-1/2" wide curb furnished by others.

Sizes:

| Model Number | Inside Curb Dimension | Model Number | Inside Curb Dimension | Model Number | Inside Curb Dimension | Model Number | Inside Curb Dimension |
|--------------|-----------------------|--------------|-----------------------|--------------|-----------------------|--------------|---------------------------|
| 1414-ALB | 14 1/4" x 14 1/4" | 6060-ALB | 60" x 60" | 2448-ALB | 24" x 48" | 3775-ALB | 37" x 75" |
| 1919-ALB | 19" x 19" | | | 2496-ALB | 24" x 96" | 3859-ALB | 38" x 59" |
| 2222-ALB | 22 1/4" x 22 1/4" | 1422-ALB | 14 1/4" x 22 1/4" | 3037-ALB | 30 1/4" x 37" | 4669-ALB | 46 1/4" x 69 1/2" |
| 3030-ALB | 30 1/4" x 30 1/4" | 1446-ALB | 14 1/4" x 46 1/4" | 3046-ALB | 30 1/4" x 46 1/4" | 4689-ALB | 46 1/4" x 89 1/2" |
| 3737-ALB | 37" x 37" | 2230-ALB | 22 1/4" x 30 1/4" | 3069-ALB | 30 1/4" x 69 1/2" | 4884-ALB | 48" x 84" |
| 4242-ALB | 42" x 42" | 2237-ALB | 22 1/4" x 37" | 3096-ALB | 30 1/4" x 96" | 4896-ALB | 48" x 96" |
| 4646-ALB | 46 1/4" x 46 1/4" | 2246-ALB | 22 1/4" x 46 1/4" | 3496-ALB | 34" x 96" | 5460-ALB | 54" x 60" |
| 4848-ALB | 48" x 48" | 2272-ALB | 22 1/4" x 72" | 3696-ALB | 36" x 96" | 6072-ALB | 60" x 72" |
| 5555-ALB | 55" x 55" | 2296-ALB | 22 1/4" x 96" | 3746-ALB | 37" x 46 1/4" | | Call for additional sizes |

Solar Heat Gain Coefficient = .31, U Factor = .37, Visible Light Transmission = 48% (Typical for CC/CNANO double glazed units)

Features:

1. Curb Mounted (**CM**)
2. Two Acrylic Color Choices: Clear Colorless (**CC**) or Medium White Translucent (**WTM**)
3. Nano Insulgel Panel Thickness: **10mm, 16mm, 20mm & 25mm**
Add highlighted suffixes to model number where applicable:
i.e. **4848-ALB-CMT-2-CC-16mm-CNANO-MF-SCAGE**

Options:

1. Insulating Double Domes (**2**)
2. Pyramid (**P**) or Double Hip (**DH**) Shaped Dome (selected sizes)
3. Low Profile Dome (**LP**) (selected sizes)
4. Frame Finish - Bronze Anodize (**BA**), Clear Anodize (**CA**), White Painted (**WP**) or Mill Finish (**MF**)
5. EPDM Curb Seal Tape (**CMT**)

Accessories: See PDS (Product Data Sheets) for these Items

1. Gladiator
 - a. Structural Curb (**SC**)
 - b. Security Grills (**SG**)
 - c. Safety Screens (**SSCRN**)
 - d. External Safety Cages (**SCAGE**)
2. Quickkit (Installation Kits)
 - a. Stainless Steel (**QKSS**)
 - b. Zinc Plated (**QKZP**)