

# Coollite I

## Solar Heat Blocker Acrylic

Industrial Skylight  
Thermally Broken

### Acrylic Dome

## Model ALIT

**Frame Material:** Aluminum  
**NFRC:** Certified  
**IECC 2015:** Meets without controls all climate zones  
**OSHA:** Meets CFR fall regulations  
**AAMA:** WDMA/CSA 101/I.S.2/A440-08 & WDMA/CSA 101/I.S.2/A440-05

#### Details:

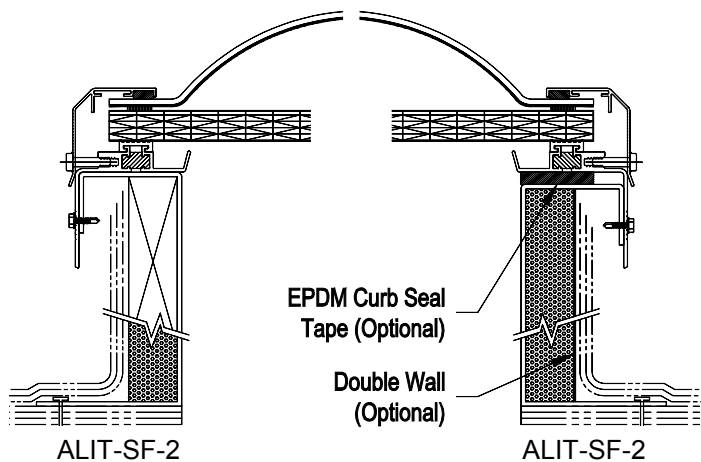

#### Specifications:

Coollite I skylight shall be model No. \_\_\_\_\_ as manufactured by Bristolite Daylighting Systems, Santa Ana, CA. Skylights shall be fully factory assembled consisting of an acrylic dome coated with an infra-red and ultraviolet blocking technology with a CC-2 classification that is sealed by interior and exterior gaskets to a 6063-T5 heliarc welded frame fabricated of aluminum and polyurethane thermal break material to prevent thermal losses through the frame and the formation of condensation on its interior surfaces plus a structural multiwall polycarbonate glazing panel. The frame is to have an integral condensation channel to carry moisture to the exterior. The aluminum retaining cap fasteners are to be corrosive resistant. The skylight frame shall be installed on its own 9" or 12" high self flashing curb fabricated from aluminum with a 2-3/4" roof nailing flange. The base is made up with 1" insulation and a wood nailer and/or an additional aluminum liner on the exterior of the self flashing curb.

#### Sizes:

Model Number	Inside Curb Dimension	Model Number	Inside Curb Dimension	Model Number	Inside Curb Dimension	Model Number	Inside Curb Dimension
1414-ALIT	14 1/4" x 14 1/4"	6060-ALIT	60" x 60"	2272-ALIT	22 1/4" x 72"	3746-ALIT	37" x 46 1/4"
1919-ALIT	19" x 19"	7070-ALIT	70 1/4" x 70 1/4"	2296-ALIT	22 1/4" x 96"	3775-ALIT	37" x 75"
2222-ALIT	22 1/4" x 22 1/4"	7575-ALIT	75" x 75"	2448-ALIT	24" x 48"	3859-ALIT	38" x 59"
3030-ALIT	30 1/4" x 30 1/4"			2496-ALIT	24" x 96"	4669-ALIT	46 1/4" x 69 1/2"
3737-ALIT	37" x 37"	1422-ALIT	14 1/4" x 22 1/4"	3037-ALIT	30 1/4" x 37"	4689-ALIT	46 1/4" x 89 1/2"
4242-ALIT	42" x 42"	1446-ALIT	14 1/4" x 46 1/4"	3046-ALIT	30 1/4" x 46 1/4"	4896-ALIT	48" x 96"
4646-ALIT	46 1/4" x 46 1/4"	2230-ALIT	22 1/4" x 30 1/4"	3069-ALIT	30 1/4" x 69 1/2"	5460-ALIT	54" x 60"
4848-ALIT	48" x 48"	2237-ALIT	22 1/4" x 37"	3096-ALIT	30 1/4" x 96"	6072-ALIT	60" x 72"
5555-ALIT	55" x 55"	2246-ALIT	22 1/4" x 46 1/4"	3496-ALIT	34" x 96"		Call for additional sizes

Solar Heat Gain Coefficient = .20, U Factor = .45, Visible Light Transmission = 50% (Typical for ACO double glazed units)

#### Features:

1. Self Flashing (SF)
2. Clear Acrylic Dome with Infra-Red & Ultraviolet Blocking Technology (ACO)
3. Insulated Curb (INS)
4. Wood Nailer (WN)
5. Two Inner Multiwall Panel Colors: Clear (C) or Opal (O)
6. 16mm Inner Multiwall Panel (16MM10)  
Add highlighted suffixes to model number where applicable:  
i.e. **4896-ALIT-SF-2-ACO-C16MM10-12-INS-WN-MF**

#### Options:

1. Insulating Double Domes (2)
2. Pyramid (P) or Double Hip (DH) Shaped Dome (selected sizes)
3. Low Profile Dome (LP) (selected sizes)
4. Frame Finish - Bronze Anodize (BA), Clear Anodize (CA), White Painted (WP) or Mill Finish (MF)

#### Options: (cont.)

5. Self Flashing Bases of 9" or 12" (9 or 12)
6. Aluminum Double Wall (DW)
7. EPDM Curb Seal Tape

#### Accessories: See PDS (Product Data Sheets) for these Items

1. Gladiator
  - a. Security Grills (SG)
  - b. Safety Screens (SSCRN)
  - c. External Safety Cages (SCAGE)

