



Fiberglass Dome

Model ESI

Frame Material: Aluminum
IECC 2015: Meets with controls all climate zones
OSHA: Meets CFR fall regulations
FM Global: Passes 4431 2" severe hail test
AAMA: WDMA/CSA 101/I.S.2/A440-08 & WDMA/CSA 101/I.S.2/A440-05

Details:

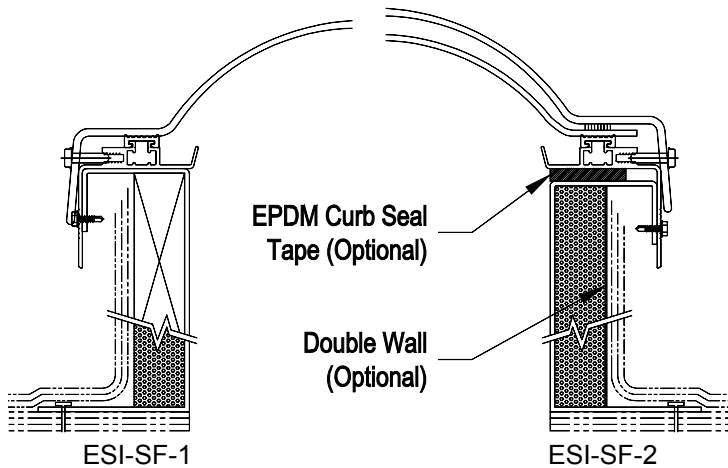

Specifications

Energy Star skylight shall be model No. _____ as manufactured by Bristolite Daylighting Systems, Santa Ana, CA. The fiberglass dome shall be an impact resistant molded one-piece unit with integral counter flashing skirt to eliminate any dependence on gaskets, sealants or flow through designs. Fiberglass shall consist of neopentyl glycol isophthalic gelcoat laminate with an acrylic modified polyester based resin with UV light stabilizers and silane glass fibers. These units are attached to a 6063-T5 heliarc welded aluminum frame and is fastened with corrosive resistant fasteners. The frame is to have an integral condensation channel. The skylight frame shall be installed on its own 9" or 12" high self flashing curb fabricated from aluminum with a 2-3/4" roof nailing flange. The base is made up with 1" insulation and a wood nailer and/or additional aluminum liner on the exterior of the self flashing curb. Dome material is self-extinguishing Approved Plastic CC-1 rated.

Sizes:

Model Number	Inside Curb Dimension	Model Number	Inside Curb Dimension	Model Number	Inside Curb Dimension	Model Number	Inside Curb Dimension
4848-ESI	47-1/2" x 47-1/2"			4896-ESI	47-1/2" x 95-1/2"		
				6072-ESI	60" x 72"		

Solar Heat Gain Coefficient = .46, U Factor = .63, Visible Light Transmission = 63% (Typical for ESA double glazed units)

Features:

1. Self Flashing (**SF**)
2. Impact Resistant (**IR**) – Can withstand a heavy impact
3. High Wind Resistant (**HW**) – Can withstand high wind conditions
4. Energy Star Glazing (**ESA**)
5. Insulated Frame (**INS**)
6. Wood Nailer (**WN**)

Add highlighted suffixes to model number where applicable:
 i.e. **4896-ESI-SF-2-ESA-IR-HW-CC-INS-WN-MF**

Options:

1. Insulating Double Domes (**2**) or Single Dome (**1**)
2. Low Profile Dome (selected sizes) (**LP**)
3. Frame Finish - Bronze Anodize (**BA**), Clear Anodize (**CA**), White Painted (**WP**) or Mill Finish (**MF**)
4. Self Flashing Bases of 9" or 12" (**9** or **12**)
5. Aluminum Double Wall (**DW**)
6. EPDM Curb Seal Tape

Accessories: See PDS (Product Data Sheets) for these Items

1. Gladiator
 - a. Security Grills (**SG**)
 - b. Safety Screens (**SSCRN**)
 - c. External Safety Cages (**SCAGE**)