

Copolyester Dome

Details:

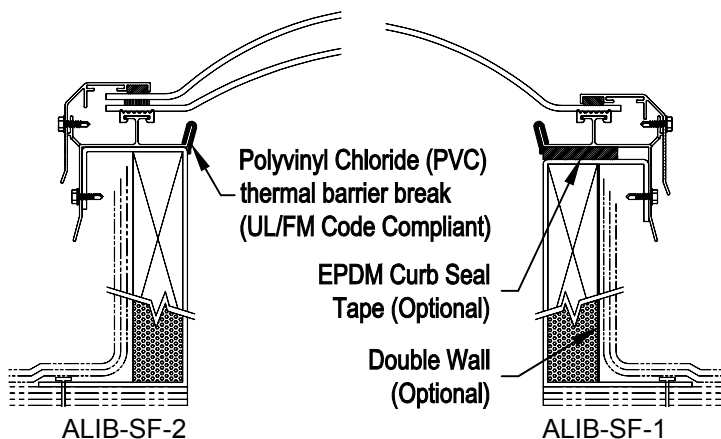

Specifications

Trituff skylight shall be model No. _____ as manufactured by Bristolite Daylighting Systems, Santa Ana, CA. The skylight shall be fully factory assembled consisting of a plastic dome (triarch shape for larger skylights) with a CC-1 classification using Trituff UL972 listed material that is sealed by interior and exterior gaskets to a 6063-T5 heliarc welded aluminum frame fabricated of aluminum with a pliable polyvinyl chloride (PVC) thermal barrier break (UL/FM Code Compliant) to prevent thermal losses through the frame and the formation of condensation on its interior surfaces. The frame is to have an integral condensation channel. The aluminum retaining cap fasteners are to be corrosive resistant. The skylight frame shall be installed on its own 9" or 12" high self flashing curb fabricated from aluminum with a 2-3/4" roof nailing flange. The base is made up with 1" insulation and a wood nailer and/or an additional aluminum liner on the exterior of the self flashing curb.

Sizes:

Model Number	Inside Curb Dimension	Model Number	Inside Curb Dimension	Model Number	Inside Curb Dimension	Model Number	Inside Curb Dimension
1414-ALIB	14 1/4" x 14 1/4"	1422-ALIB	14 1/4" x 22 1/4"	3037-ALIB	30 1/4" x 37"	3859-ALIB	38" x 59"
1919-ALIB	19" x 19"	1446-ALIB	14 1/4" x 46 1/4"	3046-ALIB	30 1/4" x 46 1/4"	4669-ALIB	46 1/4" x 69 1/2"
2222-ALIB	22 1/4" x 22 1/4"	2230-ALIB	22 1/4" x 30 1/4"	3069-ALIB	30 1/4" x 69 1/2"	4689-ALIB	46 1/4" x 89 1/2"
3030-ALIB	30 1/4" x 30 1/4"	2237-ALIB	22 1/4" x 37"	3096-ALIB	30 1/4" x 96"	4884-ALIB*	48" x 84"
3737-ALIB	37" x 37"	2246-ALIB	22 1/4" x 46 1/4"	3496-ALIB	34" x 96"	4896-ALIB*	48" x 96"
4242-ALIB	42" x 42"	2272-ALIB	22 1/4" x 72"	3696-ALIB	36" x 96"	5460-ALIB*	54" x 60"
4646-ALIB	46 1/4" x 46 1/4"	2296-ALIB	22 1/4" x 96"	36120-ALIB	36" x 120"	6072-ALIB*	60" x 72"
4848-ALIB*	48" x 48"	2448-ALIB	24" x 48"	3746-ALIB	37" x 46 1/4"	6096-ALIB*	60" x 96"
5555-ALIB*	55" x 55"	2496-ALIB	24" x 96"	3775-ALIB	37" x 75"	Call for additional sizes	

*Skylight dome in a triarch shape **only**.

Solar Heat Gain Coefficient = .50, U Factor = .65, Visible Light Transmission = 60% (Typical for HS1 double glazed units)

Features:

1. Self Flashing (**SF**)
2. White Copolyester Glazing (**HS1**)
3. Insulated Curb (**INS**)
4. Wood Nailer (**WN**)

Add highlighted suffixes to model number where applicable:
 i.e. **4896-ALIB-SF-2-HS1-CC-INS-WN-CA**

Options:

1. Insulating Double Domes (**2**) or Single Dome (**1**)
2. Low Profile Dome (selected sizes) (**LP**)
3. Frame Finish - Bronze Anodize (**BA**), Clear Anodize (**CA**), White Painted (**WP**) or Mill Finish (**MF**)
4. Self Flashing Bases of 9" or 12" (**9** or **12**)
5. Aluminum Double Wall (**DW**)

Options: (cont.)

6. EPDM Curb Seal Tape

Accessories: See PDS (Product Data Sheets) for these Items

1. Gladiator
 - a. Security Grills (**SG**)
 - b. Safety Screens (**SSCRN**)
 - c. External Safety Cages (**SCAGE**)