

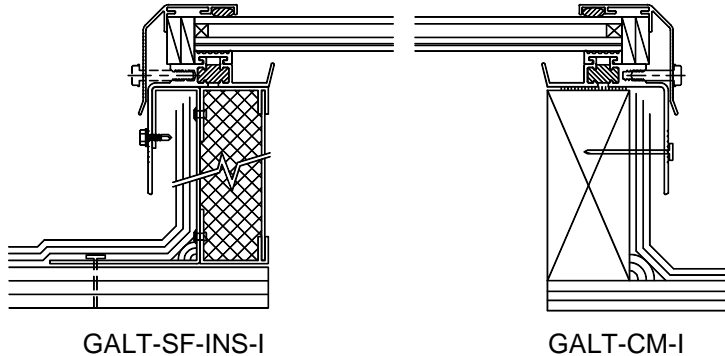

Flat Glass

Details (Scale: 3":1'-0")



Specifications

Alumilite Skylight shall be model No. \_\_\_\_\_ as manufactured by Bristolite Daylighting Systems, Santa Ana, CA. Skylights shall be fully factory assembled consisting of glass (see below) that is sealed by interior and exterior gasketing to a 6063-T5 heliarc welded aluminum frame fabricated of aluminum and polyurethane thermal break material to prevent thermal losses through the frame and the formation of condensation on its interior surfaces. The frame is to have an integral condensation. The aluminum retaining cap fasteners are to be corrosion resistant. The base frame shall be installed either on a 1-1/2" wide curb furnished by others or on its own 4", 9", or 12" high self flashing curb fabricated from aluminum with a 2-3/4" roof flange with 1" of insulation in a PVC frame and an aluminum liner on the interior of the self flashing frame.

Sizes:

Model Number	Inside Curb Dimension	Glass Type	Model Number	Inside Curb Dimension	Glass Type	Model Number	Inside Curb Dimension	Glass Type
1414-GALT	14 1/4" x 14 1/4"	A	1422-GALT	14 1/4" x 22 1/4"	A	3046-GALT	30 1/4" x 46 1/4"	A
1919-GALT	19" x 19"	A	1446-GALT	14 1/4" x 46 1/4"	A	3069-GALT	30 1/4" x 69 1/2"	B-1
2222-GALT	22 1/4" x 22 1/4"	A	2230-GALT	22 1/4" x 30 1/4"	A	3096-GALT	30 1/4" x 96"	B-HS
3030-GALT	30 1/4" x 30 1/4"	A	2237-GALT	22 1/4" x 37"	A	3746-GALT	37" x 46 1/4"	B-AN
3737-GALT	37" x 37"	A	2246-GALT	22 1/4" x 46 1/4"	A	3775-GALT	37" x 75"	B-HS
4242-GALT	42" x 42"	C	2272-GALT	22 1/4" x 72"	A	3859-GALT	38" x 59"	B-1
4646-GALT	46 1/4" x 46 1/4"	C	7222-GALT	72" x 22 1/4"	A			
4848-GALT	48" x 48"	C	2296-GALT	22 1/4" x 96"	B-1			
			3037-GALT	30 1/4" x 37"	A			

Minimum pitch of 3:12 is required for all flat glass models.

Solar Heat Gain Coefficient = .52, U Factor = .47, Visible Light Transmission = 51% (Typical for TB glazed units)

Features:

1. Curb Mounted (CM) or Self Flashing (SF)
2. Three Glass Color Choices: Bronze (TB), Grey (TG) or Clear (TC)
3. Insulated Frame (INS) (self flashing models only)
4. Double Wall Frame (DW) (self flashing models only)  
Add highlighted suffixes to model number where applicable:  
i.e. 4242-GALT-CM-I-TB/LC-BA

Options:

1. Frame Finish - Bronze Anodize (BA), Clear Anodize (CA), White Painted (WP) or Mill Finish (MF)
2. Self Flashing Bases of 9" or 12" (9 or 12)
3. Low-E Glass - PPG Solarban 60 (LE)
4. White Laminated Glass (LW)

Glass Type:

- A: 5/8" Thick Overall  
(1/8" Tempered, 1/4" Air Space, 1/4" Annealed Lam.)
- B-AN: 15/16" Thick Overall  
(1/8" Tempered, 3/8" Air Space, 7/16" Annealed Lam.)
- B-1: 1" Thick Overall  
(3/16" Tempered, 3/8" Air Space, 7/16" Annealed Lam.)
- B-HS: 1" Thick Overall  
(3/16" Tempered, 3/8" Air Space, 7/16" Heat Strengthened Lam.)
- C: 1-3/16" Thick Overall  
(1/4" Tempered, 1/2" Air Space, 7/16" Heat Strengthened Lam.)